

EPE-EM3B

LED Emergency Bulkhead

CE IP65  RoHS

INTRODUCTION

EPE-EM3B LED emergency bulkhead is controlled by smart IC, with a self-test function. It has two different output which is adjustable at the field. Left, right, up, down direction arrow pictogram legend is optional. Using the simple line and elegant element, EPE-EM3B has the ability to transcend ordinary design, as well as high product quality.

FEATURES

- Optional interchangeable legends.
- IP65 Rated.
- Efficiently and reliable LED light source.
- Suitable for wall / ceiling / recessed mounting.

Dimensions unit:mm

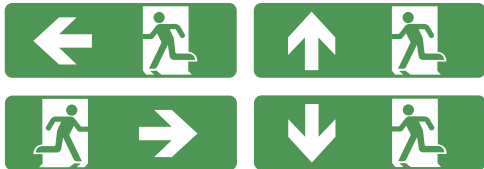
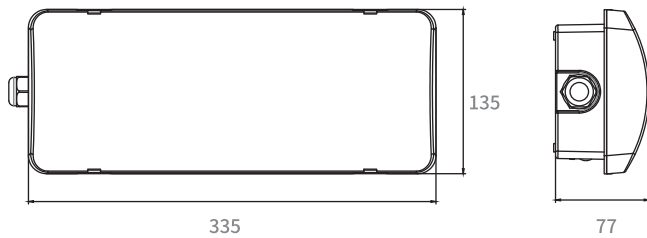

Model List

Model	Input Voltage	Emergency Power	Lumen Output	Charge Duration	DischargeDuration	Battery	Test Mode
EPE-EM3B-ST-1H	220-240V	4.5W Max	650lm	24H	1H	LiFePO4 6.4V1500mAh	AT/MT/DA
EPE-EM3B-ST-2H	220-240V	4.5W Max	650lm	24H	2H	LiFePO4 6.4V3200mAh	AT/MT/DA
EPE-EM3B-ST-3H	220-240V	4.5W Max	650lm	24H	3H	LiFePO4 6.4V3200mAh	AT/MT/DA
EPE-EM3B-HO-1H	220-240V	8W Max	1200lm	24H	1H	LiFePO4 6.4V3200mAh	AT/MT/DA
EPE-EM3B-HO-2H	220-240V	8W Max	1200lm	24H	2H	LiFePO4 6.4V6000mAh	AT/MT/DA
EPE-EM3B-HO-3H	220-240V	8W Max	1200lm	24H	3H	LiFePO4 6.4V6000mAh	AT/MT/DA

Driver Datasheet

Model	EPE-EM3B-ST	EPE-EM3B-HO
Mains power	8W Max	18W Max
Frequency	50/60Hz	50/60Hz
Input Voltage	AC220-240V	AC220-240V
Discharge Efficiency	≥70%	≥70%
Power Factor	≥0.9	≥0.9
Rated Input Current	≤0.12A	≤0.12A
Full load output voltage	DC24V	DC24V
Output current range	190mA±10%	340mA±10%
Surge	0.5KV	0.5KV
Withstand voltage	AC3750V	AC3750V

Technical Data Sheet

Model	EPE-EM3B-ST	EPE-EM3B-HO
LED	SMD 2835	SMD 2835
CCT(K)	5000K	5000K
"Luminous Flux(lm)	650lm±10%	1200lm±10%
CRI	>80	>80
LED Driver	Built-in	Built-in
Protection Class	Class II	Class II
IP Rating	IP65	IP65
IK Rating	IK07	IK07
Finishing color	White	White
Material	PC	PC
Glow wire test (°C)	COVER:850℃	COVER:850℃
Operating Temp (°C)	0℃ ~45℃	0℃ ~45℃
Storage Temp (°C)	0℃ ~65℃	0℃ ~65℃

Instructions for automatic test option

1.Once the unit is powered up it will automatically initiate a self test and diagnostics as follows:

- Every 4seconds: Checks for battery disconnection,charger board fault,lamp fault and transfer fault.
- Every month: Performs a 3minutes duration test.
- Every year:Performs a 1 hour or 3 hours duration test.

All test functions are factory preset and do not need field adjustment.

2.Dual Colour Indicator LED Status Mesnings

- Green Solid On Ready/Normal Operation
- Red Requires Service

•	One flashes, 4 seconds pause	Battery not connected
••	Two flashes, 4 seconds pause	Low battery voltage
•••	Three flashes, 4 seconds pause	Charger board fault
••••	Four flashes, 4 seconds pause	AC/DC transfer fault
•••••	Five flashes, 4 seconds pause	LED lamp fault

NOTE:After repairing a service fault,press and hole the test button for 2 seconds to reset the flashing indicator light to green.

3.Manual Testing

Press test button once	30 seconds duration test
Press test button twice within 2 seconds	3 minutes duration test
Press test button 3 times within 2 seconds	30 minutes duration test
Press test button 4 times within 2 seconds	1 hour or 3 hours duration test



▼ www.epowerem.com info@epowertech.cn TEL: +86-755 85272094 ▼
Add: 302, 6th Building, Hesheng Industrial park, FuHai Sub-district, Bao'an, Shenzhen, PRC